

P1 HEATSINK
 MAT'L: 6063-T5 ALUMINUM (AAVID EXTRUSION #60840)
 FINISH: ANODIZE PER MIL-A-8625, TYPE II, CL 2, BLACK
 TYPICAL BREAKDOWN VOLTAGE > 300V

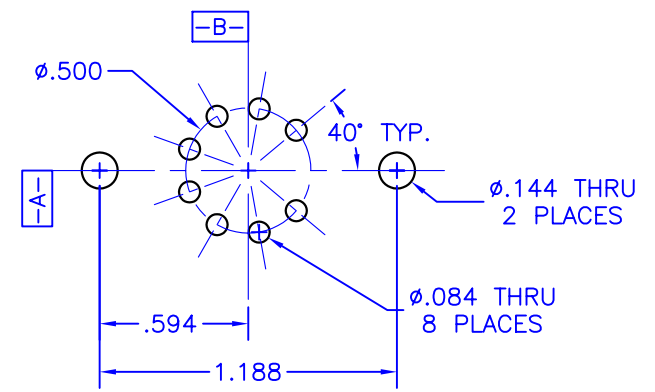

DETAIL A
 SCALE: 2X

- NOTES:**
- UNLESS OTHERWISE NOTED, ALL DIMENSIONS ARE IN INCHES.
 - BREAK ALL SHARP EDGES, DE-BURR & REMOVE LOOSE CHIPS.
 - MARK WITH CONTRASTING INK AS SHOWN, IF SPECIFIED BY PURCHASE ORDER.

TOLERANCES - UNLESS OTHERWISE SPECIFIED		TITLE		MODEL	
.XX = ±.01	.XXX = ±.005	TO3 PACKAGE HEATSINK		HS14	
ANG. = ±.5°		SUBJECT		DATE	
		MECHANICAL DRAWING		01/12/04	
END	TECH/INCL	DOA	SERIAL	FILENAME	REV
D-M	D-M	41057	1 1	HS14-F	F